

## **RSL 616-M**

### Button Type Load Cell (Miniature Compression Load Cell)

**RUDRRA SENSOR**

The load cell Technology



#### Product Description

Miniature Compression Load cell is one of the familiar load cells of the market. It is being widely used by the customers as because it can provide the accurate result in a case of industrial application. The model name is RSL 616M. The accuracy of this equipment makes it the popular in the market. It is available in various size and designs. The different models have different weights as they vary from 50 kg to 500 Kg. The product is made of using stainless steel materials to provide robustness to the equipment.

- \* It is easy to install
- \* The specific load cell can be designed as per the customization
- \* It is low profile and miniature
- \* The capacity varies from 50 kg to 500 kg
- \* It is able to complete the environmental protection of IP67 class
- \* Constructed of hard stainless steel

(RSL-616-M) Miniature Compression Load Cells are suitable for applications where Spaces are constraint.

- \* This is constructed from heat treated stainless steel suitable for harsh and hygienic industrial applications.
- \* It is sealed for IP-67 protection and it has long life.
- \* Extremely suitable for automation, tensile testing and force measurements.
- \* RSL-616-M is available with integral load button.

#### Applications

- \* Tensile testing
- \* Force and impact test
- \* Robotics
- \* Test Bench
- \* Automation
- \* Industrial Force Measurement

#### Key Features

- \* 50Kgf to 500 Kg Capacities.
- \* Complete environmental protection IP67 class.
- \* Standard output 2.0 m V/V available.
- \* Hardened stainless steel construction.
- \* Miniature and low profile.
- \* Easy for installation.
- \* Custom built design available on request

#### Optional :

- \* Digital Load cell
- \* Stainless steel structure



## RSL 616-M

### Button Type Load Cell (Miniature Compression Load Cell)

**RUDRRA SENSOR**  
The load cell Technology

Load Application Layout :

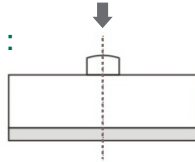

Dimensions :

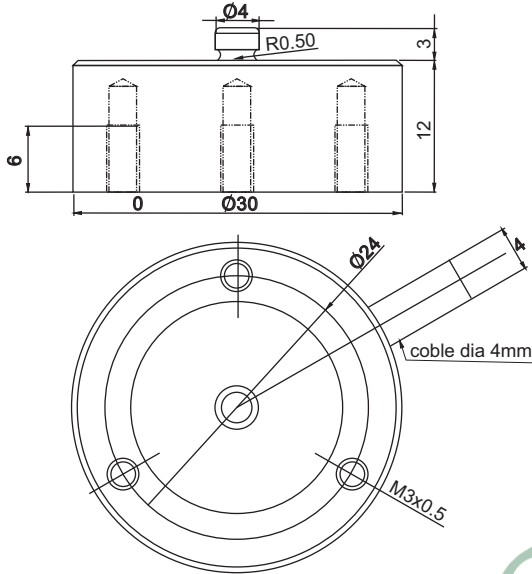

\* All dimension are in mm

Cable Connection Details :

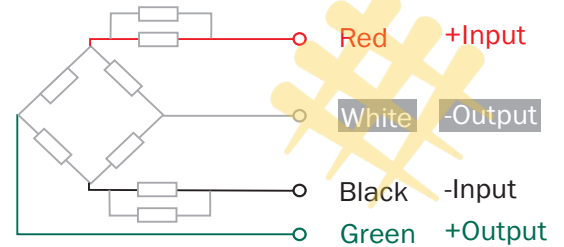

### Parameters : (Analog Load Cell)

Capacities (Kgs.) :	50, 100, 200, 500, 1000	Excitation Voltage :	5~15V (DC)
Nominal Output :	2.0 mV/V	Non - Linearity :	$< \pm 0.1\%$ FSO (Full Scale Output)
Hysteresis :	$< \pm 0.1\%$ FSO	Non - Repeatability :	$< \pm 0.1\%$ FSO
Creep (30min)	$< \pm 0.03\%$ FSO	Insulation Resistance (50V) :	$> 1000$ Mega Ohms
Input Resistance :	$390 \pm 10$ Ohms	Safe Overload	150 %
Output Resistance	$350 \pm 3$ Ohms	Temp. Effect on Zero (%FS/10 °C)	0.03 / 0.02
Ultimate Overload of Rated :	300 %	Temp. Effect on Span (%FS/10 °C)	0.03 / 0.015
Deflection :	$< 0.5$ mm at FSO	Material of Construction :	Stainless Steel - 17-4 PH
Environmental Protection Class :	IP65	Cable Length (4 core) :	3 Mtr.

